

CAN 06 Issue 1	Colortrac Ltd <b>Removing the scanner shipment tape</b>	Page 1 of 1 Date: 2009-07-30
This document intended to supplement the installation and operation manual or training and instruction sessions provided by Colortrac and its partners		

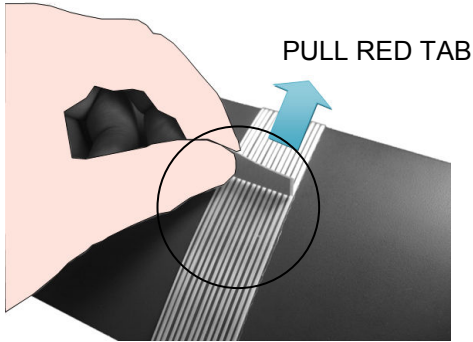

The scanner is protected during shipment by two strips of self adhesive tape which must be removed before proceeding with the installation.

Remove the shipment tapes by locating the red tab and carefully lifting the tape up and away from the scanner.



Remove both tapes completely. The tapes cannot be reused and should be disposed of.

END